

Massiv Holz-Glastüren MF/HG

Ahorn, Birke, Buche, Eiche, Erle, Esche, Lärche, Hemlock, am. Kirschbaum, Nussbaum, Pinie etc.

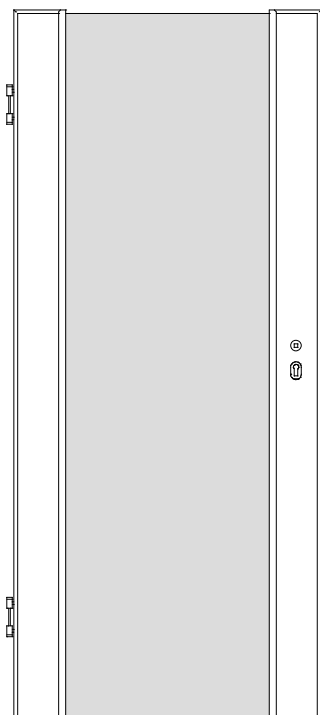

MF/HG

Türstärke ca. 42mm,
Friesbreite 142mm,
Füllung aus 8mm ESG-Glas *

Rahmen mit 5mm Starkfurnier,
Überschlag mit *Karnieskante*

Marken-BB-Schloss Stulp silberlack,
2x Bänder V0026WF vernickelt

* Lieferbares ESG-Glas:

- Chinchilla weiß*
- Klarglas*
- Madras pave*
- Madras uadi*
- Mastercarré*
- Masterpoint*
- Masterligne*
- Opti-White (Weißglas, entspiegelt)*
- Parsol grau*
- Parsol grün*
- Parsol bronze*
- Satinato*
- Silvit weiß*

oder
mattiert und
mit Motiv

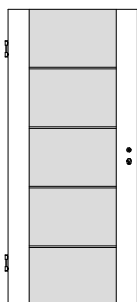

../HG-L4

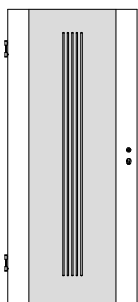

../HG-L5

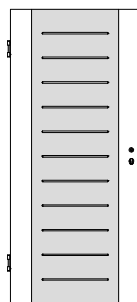

../HG-L11

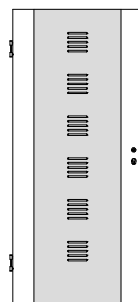

../HG-Q6

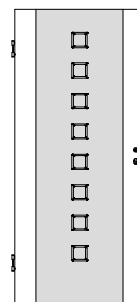

../HG-Q8

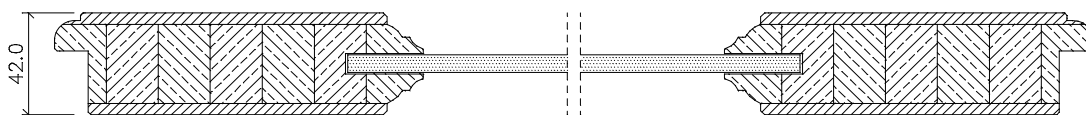

MF/HG

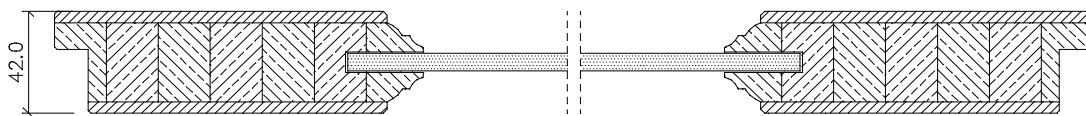

ME/HG

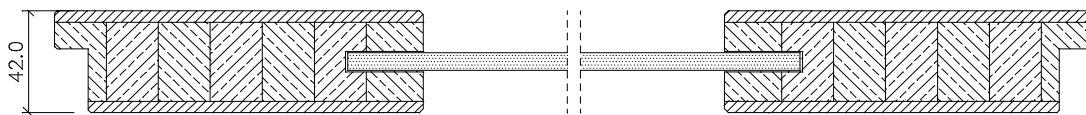

MG/HG